

2012 Chevrolet Impala 3.6L

Warning: When working on, under, or around any vehicle exercise caution. Please allow the vehicle's exhaust system to cool before removal, as exhaust system temperatures may cause severe burns. If working without a lift, always consult vehicle manual for correct lifting specifications. Always wear safety glasses and ensure a safe work area. Serious injury or death could occur if safety measures are not followed.

Step 1: (Carefully read all instructions before installation) Begin removing the OEM exhaust system by cutting the factory pipe 3" behind the weld on the underbody catalytic converter per Fig. 1. (Sheet 2) Remove the system by unfastening clamps and disengaging welded hangers from the OEM rubber insulators, do not discard or damage the OEM rubber insulators, as they will be reused to mount the new exhaust system.

Step 2: To install the new exhaust system, use a front to rear method. Using the supplied 2.50" clamp install the resonator assembly to the cut pipe. Leave all fasteners and clamps loose for the final adjustment of the complete system. Using a 2.50" clamp, install the Pipe Extension Assembly and insert the welded hanger into the OEM rubber insulator. In a similar fashion, install the "T" Pipe Assembly, Driver's and Passenger's side Muffler Assemblies and Tailpipe Assemblies.

Step 3: With all components mounted loosely, adjust the system for overall aesthetics and clearance of frame & bodywork. (MAGNAFLOW recommends at least 1/2" of clearance between the exhaust system and any body panels to prevent heat-related body damage or fire.)

Step 4: Once a final position has been chosen for the new system, evenly tighten all fasteners from front to rear. The supplied band clamps must be VERY tight to properly align the pipes and prevent leaks (Approximately 40ft-lbs). Inspect all fasteners after 25-50 miles of operation and retighten if necessary.

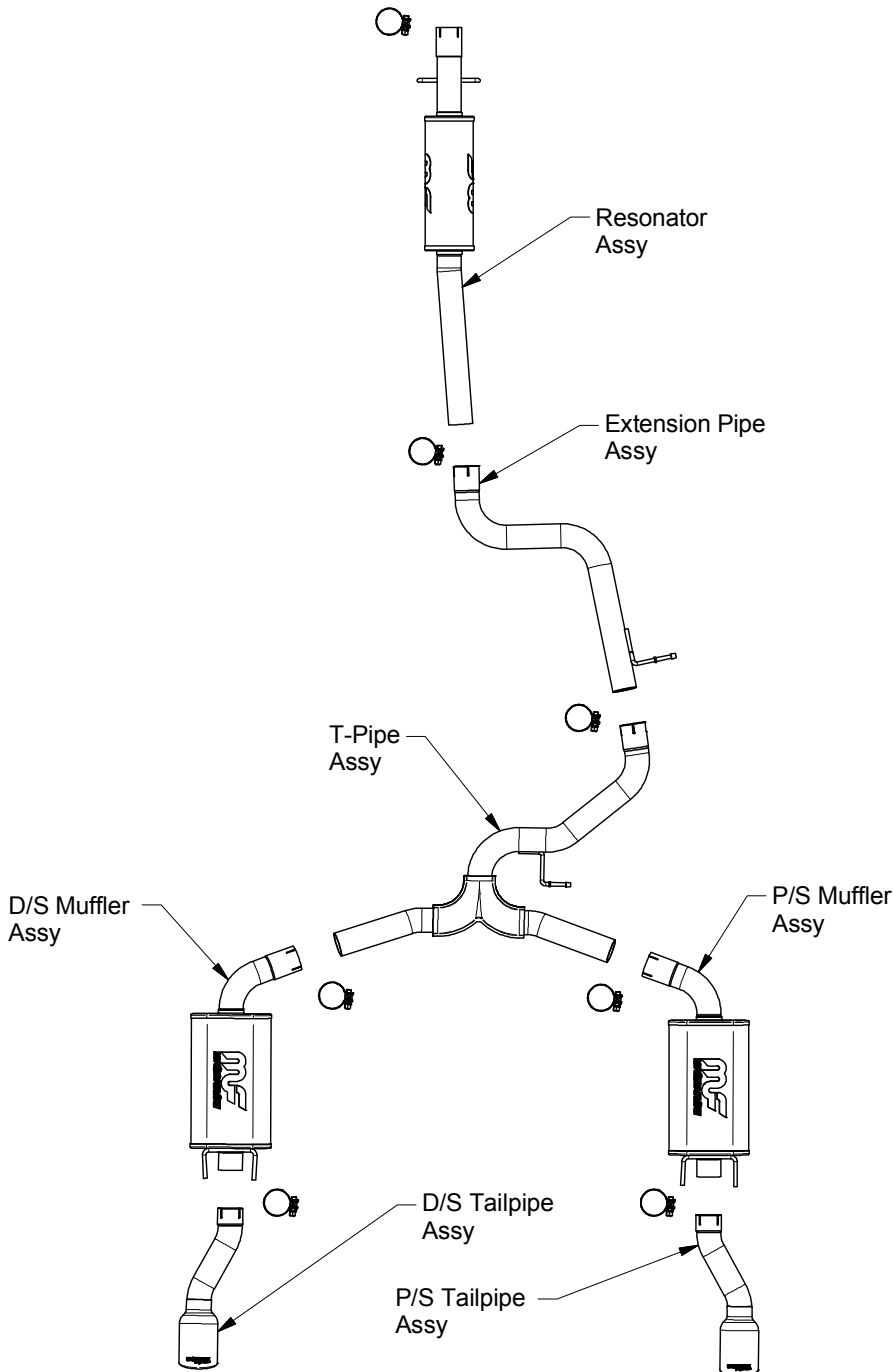

**** Magnaflow Performance Exhaust recommends professional installation on all their products**



Fig.1

Cut Point 3.00" from rear of catalytic converter weld.